

Bluerock Center

Antioch, CA

TENANT & PROJECT SIGN PROGRAM

8/15/05

7/27/06 Addendum

OWNER

Bluerock Partners, LLC 1200 Concord Avenue, Suite 200 Concord, CA 94520 925-674-8400

ENVIRONMENTAL GRAPHIC DESIGNER

Englund Designworks Inc 2261 Morello Ave. Suite D Pleasant Hill, CA 94523 925 682-3646

The Bluerock Center Sign Program has been established for the purpose of assuring professional visual graphics, imagery and communications designed to mutually benefit the business park and Bluerock Center's tenants and their clients/customers. The intent is to provide sign guidelines and criteria that are necessary to achieve a visually harmonious environment.

BLUEROCK CENTER IDENTIFICATION SIGNS

The intent of the primary center identification signing is to:

1. Clearly identify the project and/or its major tenants in a compatible design with the total development.
2. Adequately define the center's identity.

TENANT SIGNAGE

The design of the office, office flex and retail tenant signing clearly identifies individual businesses to vehicular and pedestrian traffic within and around the project site.

The design allows for individual trade/trademark style graphics within a uniform controlled and harmonious sign plan. This benefits all tenants equally throughout the project without visually dominating the architectural environment.

The following pages describe the overall sign program as well as the specifications for individual signs and graphic elements to be used throughout the project.

Conformation to the criteria and guidelines for the Bluerock Center Sign Program will be strictly enforced. Any non-conforming or unapproved signing installed by the Tenant is not permitted and shall be brought into conformance at the Tenant's expense. Only the signs described in this document are permitted in, on and within the project.

Landlord and City of Antioch must approve any changes from the Bluerock Center Sign Program. Accordingly, the Landlord must make any applications to City of Antioch for revisions to the Bluerock Center Sign Program.

GENERAL CRITERIA

A. REQUIRED SIGNS

Tenant shall provide a minimum of one primary business identification sign per store frontage with a public entrance.

Tenant's sign shall conform to the sign sizes and locations designated for its storefront area in this Criteria.

B. PROCEDURES FOR SIGNAGE APPLICATION

Landlord shall provide the Tenant the criteria (herein) for Bluerock Center Sign Program.

To obtain sign approval from Landlord, each applicant shall submit the following:

1. A completed sign approval application (contained within this booklet) at the noticed address as stated in the fundamental/basic lease provisions.
2. A completed copy of the required City of Antioch Sign Review Application.
3. Two (2) copies of scaled drawings, one of which will be colored, including all lettering and graphic diagrams and specifications for colors, construction, materials, illumination and installation. Cross-section details shall also be shown in scale along with relevant site, plot and elevation plans.

One set of approved plans and the City of Antioch Sign Review Application will be returned by Landlord to the Tenant.

C. CITY OF ANTIOCH SIGN & BUILDING PERMITS

City of Antioch written approval is required for signs.

All permits required for signing installation shall be obtained by the applicant, or his agent, at the applicant's expense.

The applicant shall be responsible for the fulfillment of all requirements and specifications contained in the sign program.

D. SIGN CONTRACTOR

Any sign contractor performing work for any Tenant shall have an applicable State of California Contractors License.

Landlord reserves the option to exclude any sign contractor from performing work on the site or buildings.

E. INSURANCE

Sign contractors shall carry WORKER'S COMPENSATION AND PUBLIC LIABILITY INSURANCE against all damage suffered or done to any and all persons and/or property while engaged in the construction or erection of signs in an appropriate amount as required by Landlord.

Contractor or Tenant shall indemnify Landlord and the City of Antioch from any damages that may arise from the installation, maintenance or use of Tenant's sign.

F. SIGN MAINTENANCE

Tenant is responsible for the maintenance and repair of their signs and lighting. The Tenant shall keep their signs and lighting in good appearance and proper operating condition at all times.

G. SIGN REMOVAL AT TENANT'S VACATION OF SPACE

At the time a Tenant vacates their space, the Tenant is to remove their sign or sign face and patch and repair the surfaces to which the signs were installed back to the original condition. This removal and repair is at the Tenant's expense.

If the Tenant fails to remove their signs and patch, replace and repair the surfaces to which the signs were installed back to the original condition, Landlord will have such work performed and charge the Tenant for the cost of the work.

H. TENANT'S SIGN HOURS OF SIGN OPERATION

Hours of sign illumination shall be consistent with the regulations, as stated in the Lease or as controlled by the Landlord.

I. BLUEROCK PARTNERS, LLC (OWNER'S) RIGHT OF REFUSAL

Landlord reserves the right to refuse acceptance of any design for aesthetic compliance to the theme of the project, or for any reason whatsoever.

J. TEMPORARY TENANT SIGNAGE

Temporary signs for grand openings or change of ownership will be allowed only with the prior written approval of Landlord and City of Antioch.

A banner permit is required from the City of Antioch. The City's ordinance states that business opening signs must be removed 15 days after the first day of such opening or within 20 days of installation, which ever occurs first.

K. LEASING SIGNS

All leasing and "For Rent" signs, throughout the entire center, are under the direct control of Landlord.

Leasing signs shall conform to the City of Antioch Sign Ordinance.

L. CODES

All signs and their installation are to meet all applicable electrical, sign, structural and building codes.

SIGN CRITERIA

A. ELECTRICAL & ILLUMINATION

1. Sign illumination shall not include flashing, moving or audible effects.
2. Exposed conduit or tubing will not be permitted.
3. All fluorescent lamps and ballasts to be 800 MA 110 volts.
4. All neon transformers will be 30 MA H.P.F. 110 volts.
5. All conductors, transformers and other equipment shall be concealed.
6. Primary electrical service to all signs shall be placed on Tenant's meter and shall be part of Tenant's construction and operating costs.

7. Electrical components shall bear the Underwriter's Laboratories (UL) label of approval, or equal, and shall also comply with all local building and electrical codes and industry standards and practices.
8. All Tenant signs will be illuminated unless otherwise specified in the attached drawings.
9. All Tenant signs will be illuminated by a tenant clock on a schedule controlled by the Landlord as defined in the lease.
10. Tenant will pay for all costs associated with providing electrical service to the signs.
11. Specified light fixtures for approved indirect sign or banner illumination are supplied and installed by the Tenant.

B. CONSTRUCTION

1. All bolts, fastenings, clips, conduit, etc., shall be hot-dipped galvanized iron or equal, stainless, aluminum, brass or bronze.
2. Where externally mounted, all items (conduits, hardware fastenings, etc.) shall be painted to match the exterior colors of the surfaces mounted thereon.
3. All manufacturers/installers are advised that prior to final acceptance, each unit may be inspected for conformance by an authorized representative of Landlord. Any signs found not to be in conformance will be rejected and removed immediately by the Tenant or Tenant's contractor at the Tenant's expense.
4. No substitutes will be accepted by Landlord whatsoever, unless so indicated in the specifications and approved by both Landlord and City of Antioch.

C. INSTALLATION

1. Locations of signs: All signs or advertising devices advertising an individual use, building, or business shall be attached to the building at a location, described herein, or in attached drawings.
2. All penetrations of the building structure and raceway required for sign installation shall be neatly sealed and continuously maintained in watertight condition.
3. Attachments of signs to the building shall be made per specifications contained herein.
4. Tenant's sign contractor shall immediately repair any damage to the building caused by sign installation. Un-repaired damage caused by Tenant's sign and/or sign contractor, shall be Tenant's responsibility to correct at Tenant's expense.
5. Tenant shall be fully responsible for the operations of Tenant's contractor.
6. Tenant's sign contractor must secure all required building permits. Fabrication and installation must comply with all local building and electrical codes.
7. All contractors must be fully licensed (California Contractors License C-45), and must provide Landlord with a certificate of liability insurance prior to commencing any work on the property.

D. TENANT COPY

1. All Tenants' signing shall be combined to consist solely of the Tenant's trade name, logo and recognizable trademark insignia. Sign copy shall not include products or services except as it may legally be part of the Tenant's trade name, logo and recognizable trademark insignia.
2. All sign copy shall have the written approval of Landlord in each case.

E. SIGN COLORS

1. Sign colors and the entire display shall be approved in writing by Landlord.
2. Colors may conform to the Tenant's color scheme, however they shall consist of primary colors.
3. No fluorescent or "day glow" colors permitted.
4. Landlord reserves the right to not allow colors to be used that are inconsistent with the building colors and overall theme colors of the project.
5. All sign mounting assemblies and hardware shall conform to the specified colors listed in the attached drawings and conform to the colors of the surface they are adjoining.

F. WARRANTY

The entire display shall be guaranteed by fabricator/installer for 5 years against defects in material and workmanship. Defective parts, displays or installation shall be replaced or repaired without charge to Landlord.

All lamps, tubes, ballasts and transformers are excluded, but such parts will be unconditionally guaranteed and replaced without charge for a period of 90 days from date of installation.

G. PROHIBITED SIGNS

1. Animated or moving signs
2. Inflatable signs, displays and exhibits.
3. Paper, cardboard, foam board, decals.
4. Interior illuminated store signs that are visible through the windows unless approved in writing by Landlord.
5. Roof mounted signs.
6. Freestanding easel, hand held or sandwich board type signs within the project or in or on public right of ways adjacent to the project.
7. Painted signs directly on walls or windows.
8. Signs which advertise a product or service that is not available on the premises.
9. Exposed neon and signs that are illuminated with or contain exposed light.
10. Signs placed on or in vehicles parked primarily for the purpose of displaying the sign.
11. Signs mounted on windows, or which can be seen through windows.
12. Signs displaying advertising or text other than the Tenant's name except where permitted. Permitted locations are shown in the sign type and elevation drawings.
13. No manufacturer labels to be visible on signs except those required by code or ordinance and those are to be located on the sign so as not to be visible from the street or walkway.

TENANT SIGN LOCATIONS

BUILDING A

A tenant is not permitted more than two signs on the building.

Location 5

SIGN DESCRIPTION: Dimensional Letters/Logo Type

Internally illuminated letters and/or logo type with translucent faces in Tenant's color

SIGN SIZE: 40 square feet maximum. Capital letter height maximum 24". Logo maximum height 36". Maximum length of sign 20'.

Location 6

SIGN DESCRIPTION: Dimensional Letters/Logo Type

Internally illuminated letters and/or logo type with translucent faces in Tenant's color

SIGN SIZE: 40 square feet maximum. Capital letter height maximum 24". Logo maximum height 36". Maximum length of sign 20'.

Location 7

SIGN DESCRIPTION: Dimensional Letters/Logo Type

Internally illuminated letters and/or logo type with translucent faces in Tenant's color

SIGN SIZE: 40 square feet maximum. Capital letter height maximum 24". Logo maximum height 36". Maximum length of sign 20'.

BUILDING B

A tenant is not permitted more than one sign per building elevation.

Location 8

SIGN DESCRIPTION: Dimensional Letter/Logo Type

Internally illuminated letters and/or logo type with translucent faces in Tenant's color

SIGN SIZE: Single Bay 2'-0" x 16'-0" x 6" thick

Single Bay: 32 Square Feet - Max cap height 2'-0". Max logo height 30".

Location 9

SIGN DESCRIPTION: Dimensional Letter/Logo Type

Internally illuminated letters and/or logo type with translucent faces in Tenant's color

SIGN SIZE: Single Bay 2'-0" x 16'-0" x 6" thick

Multiple Bay 2'-0" x 24'-0" x ~~6~~ 6" thick

Single Bay: 32 Square Feet - Max cap height 2'-0". Max logo height 30".

Multiple Bay: 48 Square Feet - Max cap height 2'-0". Max logo height 30".

Location 10

SIGN DESCRIPTION: Dimensional Letter/Logo Type

Internally illuminated letters and/or logo type with translucent faces in Tenant's color

SIGN SIZE: Single Bay 2'-0" x 16'-0" x 6" thick

Single Bay: 32 Square Feet - Max cap height 2'-0". Max logo height 30".

SPECIFIC CRITERIA BY LOCATION

Location 11

SIGN DESCRIPTION: Dimensional Letter/Logo Type

Internally illuminated letters and/or logo type with translucent faces in Tenant's color

SIGN SIZE: Single Bay 2'-0" x 16'-0" x 6" thick

Multiple Bay 2'-0" x 24'-0" x 6" thick

Single Bay: 32 Square Feet - Max cap height 2'-0". Max logo height 30".

Multiple Bay: 48 Square Feet - Max cap height 2'-0". Max logo height 30".

BUILDING C

Location 12 & 12A

SIGN DESCRIPTION: Dimensional Letter/Logo Type

Internally illuminated letters and/or logo type with translucent faces in Tenant's color

SIGN SIZE: Single Bay 2'-0" x 16'-0" x 6" thick

Multiple Bay 2'-0" x 24'-0" x 8" thick

Single Bay: 32 Square Feet - Max cap height 2'-0". Max logo height 30".

Multiple Bay: 48 Square Feet - Max cap height 2'-0". Max logo height 30".

Location 13 & 13A

SIGN DESCRIPTION: Dimensional Letter/Logo Type

Internally illuminated letters and/or logo type with translucent faces in Tenant's color

SIGN SIZE: Single Bay 2'-0" x 16'-0" x 6" thick

Single Bay: 32 Square Feet - Max cap height 2'-0". Max logo height 30".

FUTURE CONSTRUCTION

Certain areas of the Bluerock Center site have options for the type of building to be constructed in the future. The Criteria addresses the various sign guidelines based upon various types of buildings that may be constructed.

AREA 1

A - TWO STORY OFFICE BUILDING OPTION

A tenant is not permitted more than two signs on the building.

Location 19

SIGN DESCRIPTION: Dimensional Letters/Logo Type

Internally illuminated letters and/or logo type with translucent faces in Tenant's color

SIGN SIZE: 40 square feet maximum. Capital letter height maximum 24". Logo maximum height 36". Maximum length of sign 20'.

Location 20

SIGN DESCRIPTION: Dimensional Letters/Logo Type

Internally illuminated letters and/or logo type with translucent faces in Tenant's color

SIGN SIZE: 40 square feet maximum. Capital letter height maximum 24". Logo maximum height 36". Maximum length of sign 20'.

Location 21

SIGN DESCRIPTION: Dimensional Letters/Logo Type

Internally illuminated letters and/or logo type with translucent faces in Tenant's color

SIGN SIZE: 40 square feet maximum. Capital letter height maximum 24". Logo maximum height 36". Maximum length of sign 20'.

B - SINGLE STORY OFFICE BUILDING OPTION

A tenant is not permitted more than two signs on the building.

Location 19

SIGN DESCRIPTION: Dimensional Letters/Logo Type

Internally illuminated letters and/or logo type with translucent faces in Tenant's color

SIGN SIZE: 40 square feet maximum. Capital letter height maximum 24". Logo maximum height 30". Maximum length of sign 20'.

Location 20

SIGN DESCRIPTION: Dimensional Letters/Logo Type

Internally illuminated letters and/or logo type with translucent faces in Tenant's color

SIGN SIZE: 40 square feet maximum. Capital letter height maximum 24". Logo maximum height 30". Maximum length of sign 20'.

Location 21

SIGN DESCRIPTION: Dimensional Letters/Logo Type

Internally illuminated letters and/or logo type with translucent faces in Tenant's color

SPECIFIC CRITERIA BY LOCATION

SIGN SIZE: 40 square feet maximum. Capital letter height maximum 24". Logo maximum height 30". Maximum length of sign 20'.

AREA 2

The following defines criteria for two possible types of buildings. In both options, a tenant is not permitted more than one sign per building elevation.

A - OFFICE/COMMERCIAL BUILDING OPTION

~~A tenant is not permitted more than two signs on the building.~~

Location 22

SIGN DESCRIPTION: Dimensional Letters/Logo Type

Internally illuminated letters and/or logo type with translucent faces in Tenant's color

SIGN SIZE: Single Bay 2'-0" x 16'-0" x 6" thick, 32 Square Feet - Max cap height 2'-0". Max logo height 30".

Location 23

SIGN DESCRIPTION: Dimensional Letter/Logo Type

Internally illuminated letters and/or logo type with translucent faces in Tenant's color

SIGN SIZE: Single Bay - 32 square feet maximum. Capital letter height maximum 24". Logo maximum height 30". Maximum length of sign 16'. Multiple Bay: 40 square feet maximum. Capital letter height maximum 24". Logo maximum height 30". Maximum length of sign 20'.

Location 24

SIGN DESCRIPTION: Dimensional Letters/Logo Type

Internally illuminated letters and/or logo type with translucent faces in Tenant's color

SIGN SIZE: Single Bay 2'-0" x 16'-0" x 6" thick, 32 Square Feet - Max cap height 2'-0". Max logo height 30".

Location 25

SIGN DESCRIPTION: Dimensional Letter/Logo Type

Internally illuminated letters and/or logo type with translucent faces in Tenant's color

SIGN SIZE: Single Bay - 32 square feet maximum. Capital letter height maximum 24". Logo maximum height 30". Maximum length of sign 16'. Multiple Bay: 40 square feet maximum. Capital letter height maximum 24". Logo maximum height 30". Maximum length of sign 20'.

B - SINGLE STORY OFFICE BUILDING OPTION

A tenant is not permitted more than two signs on the building.

Location 22

SIGN DESCRIPTION: Dimensional Letters/Logo Type

Internally illuminated letters and/or logo type with translucent faces in Tenant's color

SIGN SIZE: Single Bay 2'-0" x 16'-0" x 6" thick, 32 Square Feet - Max cap height 2'-0", Max logo height 30".

Location 23

Sign Type C1

SPECIFIC CRITERIA BY LOCATION

SIGN DESCRIPTION: Dimensional Sign Panel

Non illuminated sign panel mounted to building or canopy directly above tenant space.

SIGN SIZE: 1'-3" x 8'-0" Tenant sign panel

Location 24

SIGN DESCRIPTION: Dimensional Letters/Logo Type

Internally illuminated letters and/or logo type with translucent faces in Tenant's color

SIGN SIZE: Single Bay 2'-0" x 16'-0" x 6" thick, 32 Square Feet - Max cap height 2'-0". Max logo height 30".

Location 25

Sign Type C1

SIGN DESCRIPTION: Dimensional Sign Panel

Non illuminated sign panel mounted to building or canopy directly above tenant entrance.

SIGN SIZE: 1'-3" x 8'-0" Tenant sign panel

AREA 3

The following defines criteria for four possible types of buildings. In all options, a tenant is not permitted more than one sign per building elevation.

A - TWO STORY OFFICE BUILDING OPTION

A tenant is not permitted more than two signs on the building.

Building Signs

Up to 3 locations with each on a different elevation.

SIGN DESCRIPTION: Dimensional Letters/Logo Type

Internally illuminated letters and/or logo type with translucent faces in Tenant's color

SIGN SIZE: 40 square feet maximum. Capital letter height maximum 24". Logo maximum height 36". Maximum length of sign 20'.

Monument Sign Location

SIGN TYPE: M02

SIGN DESCRIPTION: Double Sided Illuminated Monolith Sign

SIGN SIZE: 5'-0" x 8'-6" x 2'-8" thick

TYPE AREA: 2 panels at 10 1/5" x 7'-0" (6 sq. ft.) per side.

COLORS: Clear anodized aluminum/burgundy cabinet with stone accent. Copy in tenant colors.

Double sided internally illuminated fabricated free standing sign with stone accent and push through logo type. Sign to provide identification to the office building.

B - SINGLE STORY OFFICE BUILDING OPTION

A tenant is not permitted more than two signs on the building.

Building Signs

SPECIFIC CRITERIA BY LOCATION

SIGN DESCRIPTION: Dimensional Letters/Logo Type

Internally illuminated letters and/or logo type with translucent faces in Tenant's color

SIGN SIZE: 2'-0" x 16'-0" x 6" thick, 32 Square Feet - Max cap height 2'-0". Max logo height 30".

Monument Sign

SIGN TYPE A2A

SIGN DESCRIPTION: Building identification sign with address

Double sided non illuminated brushed aluminum monument sign with 5 changeable copy panels each side.

SIGN SIZE: Single Bay 4'-7" x 5'-6" x 7" thick

1 Square Feet - Max cap height 3" per panel with 5 panels each side

Tenant Bay/Entrance Identification

Sign Type C1

SIGN DESCRIPTION: Dimensional Sign Panel

Non illuminated sign panel mounted to building or canopy directly above tenant entrance.

SIGN SIZE: 1'-3" x 8'-0" Tenant sign panel

C - SINGLE STORY OFFICE BUILDING OPTION, DUAL SIDED

A tenant is not permitted more than two signs on the building.

Building Signs

SIGN DESCRIPTION: Dimensional Letters/Logo Type

Internally illuminated letters and/or logo type with translucent faces in Tenant's color

SIGN SIZE: 2'-0" x 16'-0" x 6" thick, 32 Square Feet - Max cap height 2'-0". Max logo height 30".

Monument Sign

SIGN TYPE A2A

SIGN DESCRIPTION: Building identification sign with address

Double sided non illuminated brushed aluminum monument sign with 5 changeable copy panels each side.

SIGN SIZE: Single Bay 4'-7" x 5'-6" x 7" thick

1 Square Feet - Max cap height 3" per panel with 5 panels each side

Tenant Bay

Sign Type C1

SIGN DESCRIPTION: Dimensional Sign Panel

Non illuminated sign panel mounted to building or canopy directly above tenant space on both sides of the building.

SIGN SIZE: 1'-3" x 8'-0" Tenant sign panel

D - SINGLE STORY OFFICE/FLEX BUILDING

A tenant is not permitted more than two signs on the building.

Building Signs

SPECIFIC CRITERIA BY LOCATION

SIGN DESCRIPTION: Dimensional Letters/Logo Type

Internally illuminated letters and/or logo type with translucent faces in Tenant's color

SIGN SIZE: 2'-0" x 16'-0" x 6" thick, 32 Square Feet - Max cap height 2'-0". Max logo height 30".

Monument Sign

SIGN TYPE A2A

SIGN DESCRIPTION: Building identification sign with address

Double sided non illuminated brushed aluminum monument sign with 5 changeable copy panels each side.

SIGN SIZE: Single Bay 4'-7" x 5'-6" x 7" thick

1 Square Feet - Max cap height 3" per panel with 5 panels each side

Tenant Bay/Entrance Identification

Sign Type C1

SIGN DESCRIPTION: Dimensional Sign Panel

Non illuminated sign panel mounted to building or canopy directly above tenant entrance.

SIGN SIZE: 1'-3" x 8'-0" Tenant sign panel

Miscellaneous Signs

The following various type of signs apply to all Tenants.

SIGN TYPE Z1

Tenant's Address

Tenant's address is required and is to be installed centered above entrance door to the Tenant's space.

SIGN TYPE Z2

Tenant's Rear Entry Sign

Identifies non-customer service/delivery door for receiving merchandise. Sign is to contain the Tenant's address and name. Receiving hours can also be listed on the sign.

If more than one Tenant shares the same door, each additional Tenant's name and suite number shall be applied below the first Tenant's name.

SIGN TYPE Z3

Tenant's Miscellaneous Window Signs

Certain miscellaneous signs will be permitted on storefront windows. These consist of credit card decals, hours of operation and selected other instructional information, such as phone numbers to be called in case of an emergency.

Tenants are required to post, on the glass, the hours of operation for each day of the week.

Signs are to be placed only at the entrance door or on the window immediately adjacent to the left side of the entrance door on the inside of the glass. The credit card decals shall be only those that are provided by the credit card company. Any text or message beyond hours of operation, credit cards honored and emergency information will require Landlord written approval prior to installation.

SIGN TYPE Z5

Tenant's Window Graphics

Graphics (name, service or logo) of the Tenant applied to the store front windows can be in the trade style and color of the Tenant.

They must be located within the Tenant's premises and on the glass in the prescribed location on the window.

All window graphics and their text are to be approved by Landlord in writing prior to installation.

BLUEROCK CENTER PROJECT SIGNS

Location: 1

SIGN TYPE: L01

Dimensional Property Identification Letters

SIGN SIZE: ~~Single Bay~~ 2'-4" x 12'-0" x 8" thick, 28 square feet

COLORS: Vertical brushed stainless steel with burgundy returns.

Free standing stainless steel dimensional letters mounted to concrete with up lighting.

Location: ~~2 & 3~~ 2, 3 & 4

SIGN TYPE: M01

Double Sided Illuminated Monolith Sign

SIGN SIZE: 5'-0" x 8'-6" x 2'-8" thick

TYPE AREA: 3 panels at 10 1/2" x 7'-0" (6 sq. ft.) per side.

COLORS: Clear anodized brushed aluminum/burgundy cabinet with stone accent. Logotype copy in Tenant colors.

Double sided internally illuminated fabricated free standing sign with stone accent and push through logo type. Sign to provide identification to three Center tenants.

Location: ~~4 & 18~~

SIGN TYPE: M02

Double Sided Illuminated Driveway Entrance Monolith Sign

SIGN SIZE: 5'-0" x 8'-6" x 2'-8" thick

TYPE AREA: 2 panels at 10 1/2" x 7'-0" (6 sq. ft.) per side.

COLORS: Clear anodized brushed aluminum/burgundy cabinet with stone accent and purple dimensional copy. Logotype copy in tenant colors.

Double sided internally illuminated fabricated free standing sign with push through logo type and stone accent with dimensional site identification copy. Sign to provide identification to the Center driveway, property name and two tenants.

DIRECTIONAL SIGNS

Location: 14, 15, 16 & 17

SIGN TYPE A2A

SIGN DESCRIPTION: Directional Sign

Double sided non illuminated brushed aluminum monument sign with 5 changeable copy panels each side.

SIGN SIZE: Single Bay 4'-7" x 5'-6" x 7" thick

1 Square Feet - Max cap height 3" per panel with 5 panels each side

DESCRIPTION KEY

- # Tenant Signs
- # Directional Sign
- # Illuminated Monument Signs
- # Addendum

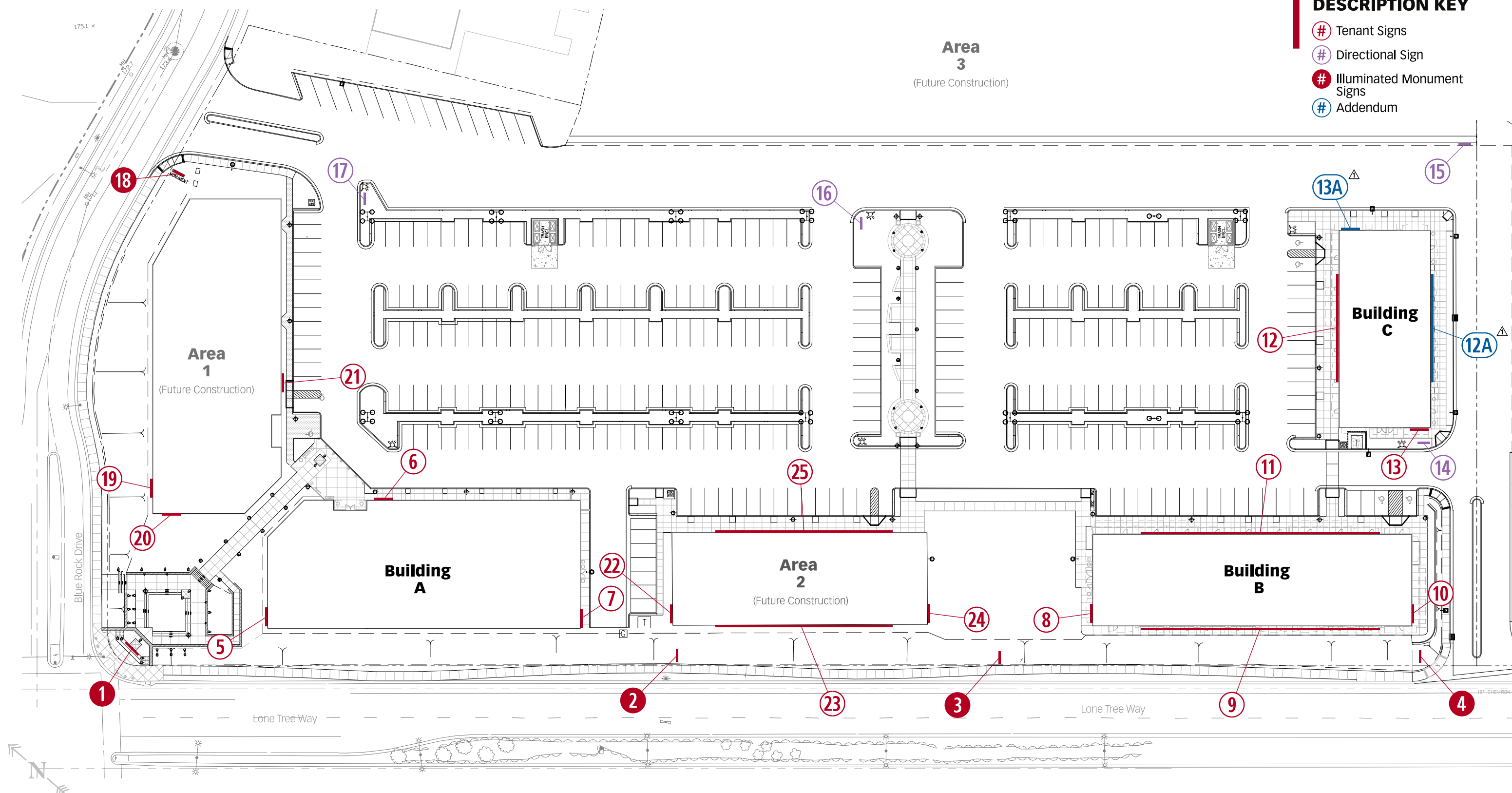

Design, plans & ideas expressed in this drawing are confidential property of Englund Designworks. Nothing in this drawing is to be reproduced, copied or disclosed to any person or entity without written permission of Englund Designworks.

Revised 7/27/06

COPYRIGHT © 2005 Englund Designworks Inc.