



PARKS & RECREATION COMMISSION MEETING

NOTE THE MEETING CHANGE

Thursday
August 20, 2020
7:00 p.m.

AGENDA

PURSUANT TO GOVERNOR GAVIN NEWSOM'S EXECUTIVE ORDER N-29-20 AND THE ORDER OF THE HEALTH OFFICER OF CONTRA COSTA COUNTY CONCERNING THE NOVEL CORONAVIRUS DISEASE THIS MEETING WILL BE HELD AS A TELECONFERENCE/VIRTUAL MEETING. OBSERVERS MAY VIEW THE MEETING LIVESTREAMED VIA THE RECREATION DEPARTMENT'S WEBSITE AT:

<https://antiochca.gov/parksandrecreationmeeting>

Notice of Opportunity to Address the Parks and Recreation Commission

There are two ways to submit public comments to the Commission:

Prior to 7:00pm the day of the meeting written comments may be submitted electronically to the Director of Parks and Recreation at the following email address: nkaiser@ci.antioch.ca.us. Include your comments in the email communication.

All comments received before 7:00 pm the day of the meeting will be provided to the Parks and Recreation Commissioners at the meeting. **Please indicate the agenda item and title in your email subject line.**

After 7:00 the day of the meeting and during the meeting all comments may be submitted verbally by dialing (925)779-7078. Call-in comments will be heard by Commissioners during the virtual meeting.

The meetings are accessible to those with disabilities. Auxiliary aides will be made available for persons with hearing or vision disabilities upon request in advance at (925) 779-7078 or TDD (925) 779-7081. Agenda and related writings provided to Commission members are available for viewing by the public during normal office hours at the Antioch Community Center, located at 4703 Lone Tree Way, Antioch, CA 94531, as well as at the Committee meeting. Individuals may view the agenda and related writings on the City of Antioch website: www.ci.antioch.ca.us



PARKS & RECREATION COMMISSION MEETING

August 20, 2020

AGENDA

I. CALL TO ORDER

II. PLEDGE OF ALLEGIANCE

III. ROLL CALL

IV. PUBLIC COMMENTS

Residents are given the opportunity to address the Commission on Park and Recreation issues not on the regular agenda.

V. APPROVAL OF MINUTES

Recommended Action:

1. Motion to approve annotated agenda minutes of the Parks and Recreation Commission meeting of July 16, 2020.

VI. BUSINESS

1. Park Ridge "Park" Approval and Recommendation to Planning Commission and City Council
2. Oral Report on COVID-19 Updates and Projections Through 2020

VII. COMMUNICATIONS (Announcements and Correspondence)

1. Staff Communication
2. Commission Communication

VIII. ADJOURNMENT

The meetings are accessible to those with disabilities. Auxiliary aides will be made available for persons with hearing or vision disabilities upon request in advance at (925) 779-7078 or TDD (925) 779-7081. Agenda and related writings provided to Commission members are available for viewing by the public during normal office hours at the Antioch Community Center, located at 4703 Lone Tree Way, Antioch, CA 94531, as well as at the Committee meeting. Individuals may view the agenda and related writings on the City of Antioch website: www.ci.antioch.ca.us



PARKS & RECREATION COMMISSION MEETING

NOTE THE MEETING LOCATION CHANGE

**Antioch Community Center
4703 Lone Tree Way
Antioch, CA 94531**

**Thursday
July 16 2020
7:00 p.m.**

ANNOTTATED AGENDA

I. CALL TO ORDER

Call to Order by Chair Arce at 7:05 pm

II. PLEDGE OF ALLEGIANCE

Chair Arce led the Pledge of Allegiance

III. ROLL CALL

*Commissioners Present: Arce, Eubanks, Knight, McClelland, Peckenham
Commissioners Absent: Belche, Foster,
Staff Present: Nancy Kaiser, Parks and Recreation Director
John Samuelson, Public Works
Wayne Burgess, Public Works*

IV. PUBLIC COMMENTS

Residents are given the opportunity to address the Commission on Park and Recreation issues not on the regular agenda.

There were no public comments

V. APPROVAL OF MINUTES

Recommended Action:

1. Motion to approve annotated agenda minutes of the Parks and Recreation Commission meeting of May 21, 2020.

*Motion to Approve Minutes for Meeting of May 21, 2020 4 Yes / 0 No
1 Abstain
2 Absent*

VI. BUSINESS

1. Park Ridge "Park" Approval and Recommendation to Planning Commission and City Council

The meetings are accessible to those with disabilities. Auxiliary aides will be made available for persons with hearing or vision disabilities upon request in advance at (925) 779-7078 or TDD (925) 779-7081. Agenda and related writings provided to Commission members are available for viewing by the public during normal office hours at the Antioch Community Center, located at 4703 Lone Tree Way, Antioch, CA 94531, as well as at the Committee meeting. Individuals may view the agenda and related writings on the City of Antioch website: www.ci.antioch.ca.us

Public Works Director John Samuelson requested that this item be continued to a future date. The applicant representing the Park Ridge Subdivision had additional questions and modifications regarding the proposed park plans for the 8.22 acre park. Members of the Commission reviewed the proposed park plans and asked some questions for basic clarification.

Motion to Continue this item, the Review, Approval and Recommendation of proposed park plan to a future date to be determined by staff.

5 Yes / 0 No

2 Absent

VII. COMMUNICATIONS (Announcements and Correspondence)

1. Staff Communication

COVID-19 continues to impact city services and facilities however, some programs have adapted and are able to meet the rules and health requirements in place. Coyote Hills Summer Camp is being offered for small groups of children and takes place outside. The Water Park opened for lap swim in June and family swim in July per the health requirements. Advance reservations are required for the family swim opportunities. Summer concerts and July 4th festivities are cancelled however staff is going to take music to the neighborhoods and promote “dancing in your driveway.” The Gymnasium is being used for blood drives – a priority health need in the community. The Fall Recreation Guide will look different, but it will still be published late August. Parking lot gates were opened July 1st, and restrooms were also reopened for use. Large gatherings and recreational team sports are still not allowed, and Playgrounds are still closed per the County Health Orders.

2. Commission Communication

Members of the Commission asked about the condition of portable toilets in some parks; they were placed as an interim option. Also, with restrooms open Commissioners asked about the availability of soap in restrooms. It was noted that caution tape was at Harbour Park due to glass, which was in the process of being screened and cleaned. Commissioners requested a grand opening of Chichibu Park when it is feasible, promoting nonprofits such as the Historical Society, and the opportunity to create a parks and recreation Instagram Page. Staff will follow up when appropriate.

VIII. ADJOURNMENT

The meeting adjourned at 7:50pm

The meetings are accessible to those with disabilities. Auxiliary aides will be made available for persons with hearing or vision disabilities upon request in advance at (925) 779-7078 or TDD (925) 779-7081. Agenda and related writings provided to Commission members are available for viewing by the public during normal office hours at the Antioch Community Center, located at 4703 Lone Tree Way, Antioch, CA 94531, as well as at the Committee meeting. Individuals may view the agenda and related writings on the City of Antioch website: www.ci.antioch.ca.us



STAFF REPORT TO THE PARKS AND RECREATION COMMISSION

DATE: Regular Meeting of August 20, 2020
TO: Parks and Recreation Commission
SUBMITTED BY: Vicky Lau, Junior Engineer
REVIEWED BY: Scott Buenting, Project Manager
APPROVED BY: John D. Samuelson, Public Works Director/City Engineer
SUBJECT: "Park Ridge Park" – Commission Approval

RECOMMENDED ACTION

Staff recommends that the Parks and Recreation Commission recommend approval of the "Park Ridge Park" Conceptual Landscape Plans to the Planning Commission and City Council subject to the conditions in this report and as discussed in the meeting.

DISCUSSION

The Park Ridge subdivision project was approved by the City Council on March 9, 2010 consisting of approximately 25 acres of passive open space and approximately 8.22 acres consisting of neighborhood park.

Several of the Conditions of Approval include:

- 1) The Developer shall dedicate the 25.5 acres of open space (Parcel H) to the City of Antioch with the Final Map.
- 2) The open space shall be named "Valeriano and Guiseppina Jacuzzi Knolls Open Space".
- 3) The developer shall dedicate land to the City, design, and construct an 8.22 acres park (Parcel G). which shall be sheet graded at a maximum of a 2% slope. A trail, with the material to be approved by the City Engineer, shall be provided from Pinnacle View Way through the neighborhood park through the open space ending at Treeline Way and Laurel Road. All environmental clearances, right of ways and easements shall be acquired by the developer at no cost to the City. The park will be completed by the issuance of the 271st building permit.
- 4) The 8.22 acres local park design including the parking lot and restrooms shall be reviewed and approved by the Parks and Recreation Commission, Planning Commission, and City Council.

VI-1

Agenda Item #

- 5) This project is subject to the current Community Park Fee and Future Community Park Fees as established and levied by the City Council.

These items are to be reviewed by the Parks and Recreation Commission and recommendations made to the Planning commission and City Council. Staff has reviewed the conceptual plans and recommends the Parks and Recreation Commission consider the following conditions in their recommendation to the Planning Commission and City Council.

Parcel H – Valeriano and Guiseppina Jacuzzi Knolls Open Space

- 1) The developer shall place two rock monuments at each trail entrance with a plaque memorializing the names.
- 2) The location and design of the rock monuments and the plaque scripts shall be reviewed and approved by Staff.

Parcel G – Park Ridge Park

- 1) Surface treatments, fencing, planting, irrigation and other items shall be complementary to Park Ridge and City Park standards for ease of maintenance as approved by the City Engineer.
- 2) Provide pathway security lighting with motion sensor and dimming features as approved by the City Engineer.
- 3) Provide for adequate and positive drainage of all site areas as approved by the City Engineer
- 4) Provide bollards at all street access points as approved by the City Engineer.
- 5) Provide a three (3') foot high, green chain link vinyl clad perimeter fence or other means of preventing vehicle access to the parks along all street frontages as approved by the City Engineer.
- 6) Provide enough trash and recycling receptacles, especially at locations where paths meet as approved by the City Engineer.
- 7) Provide barbecue areas near picnic areas as approved by the City Engineer and Parks and Recreation Commission.
- 8) Furnish and install standard City of Antioch park name signs as well as park watch signs at the main park entrances as approved by the City Engineer.
- 9) Children play area will be accessible with poured-in-place mat.
- 10) Install two play lots large enough to accommodate two sets of play structures including swings per playground standards and consumer products safety commission (CPSC) directives. One set of structures for children ages 2-5 and the second set for children ages 5-12.

- 11) Provide drinking fountains near the children's play area and meadow/field.
- 12) Provide a dog park as approved by the City Engineer.
- 13) Provide water and sewer stubs and a suitable location for a restroom facility including drinking fountains as approved by the City Engineer.
- 14) Provide bicycle racks near the main play areas and meadow/field as approved by the City Engineer.
- 15) All concrete walkways around the park are either 5 or 8 feet wide. The 8 feet pathways are for use by City maintenance vehicles, will be determined and approved by the City Engineer.
- 16) Provide 8' wide pathways and resting/viewing areas for the "Open Space" area. Materials will be determined and approved by the City Engineer.
- 17) Construct a shade structure near the play area over 35% of the group picnic tables as approved by the City Engineer.
- 18) Provide path access to basketball courts, soccer and baseball fields.
- 19) Provide basketball courts with black asphalt surface treatment
- 20) Provide ADA compliant ramps opposite all paths with crosswalks, signs, and legends as approved by the City Engineer.
- 21) Fencing adjacent to residential lots shall be 6 feet black vinyl clad chain link, solid wood, if already approved on development plans, or wood and wire as approved by the City Engineer.
- 22) Fencing adjacent to "Open Space" (trails and basins), shall be 3 feet green vinyl clad chain link, solid wood or wood and wire as approved by the City Engineer.

ATTACHMENTS:

- A. "Park Ridge Park" Conceptual Landscape Plans and Cost Estimates

ATTACHMENT 'A'

ENVIRONMENTAL FORESIGHT, INC.
Landscape Architecture
10000 Wilshire Blvd., Suite 1000
Beverly Hills, CA 90210
T: (310) 946-0300
www.environmentalforesight.com



DAVIDSON HOMES

PARK RIDGE PARK
City of Antioch, Contra Costa County, California



PROGRAM AMENITY LEGEND

- 1 PARKING LOT W/ EVERGREEN SHRUBS AND SHADE TREES (AS PAVED SPACES TOTAL)
- 40 VISITOR PARKING SPACES
- 2 LOADING/UNLOADING SPACES
- 2 PROPERTY LINE, TYPICAL
- 3 VEHICULAR SWING GATE WITH INFORMATIONAL SIGNAGE (OPERATION HOUR: 10:00 AM - 6:00 PM)
- 4 PEDESTRIAN ENTRY & PASSENGER DROP-OFF AREA
- 5 PARK ENTRY SIGNAGE
- 6 RESTROOM FACILITY PER CITY STANDARD W/ (OPERATION HOUR: 10:00 AM - 6:00 PM)
- ADA COMPLIANT
- ADA BENCH SEATING
- TRASH RECEPTACLES
- VEGETATIVE BUFFER
- 7 SCULPTURAL LANDSCAPE MONUMENT, TYPICAL
- 8 ADA ACCESSIBLE CONCRETE PARK PATHWAYS, TYPICAL (8'-0" W/ 6'-0" WIDE)
- 9 BASKETBALL COURTS (4) W/ 6'-0" WIDE AREA
- ADA BENCH SEATING
- TRASH RECEPTACLES
- VEGETATIVE BUFFERING
- 10 2-5 PLAY EQUIPMENT BY MIRAGE PLAY, INC.
- 2-5 PLAY EQUIPMENT BY MIRAGE PLAY, INC.
- CONCRETE PAVEMENT IN RECOMMENDED GRANITE W/ SHADE TREE
- VEGETATIVE BUFFERING
- 11 5'-6" PLAYGROUND AREA W/ 6'-0" WIDE PLAY, INC.
- ADA ACCESSIBLE PATH AND LANDING
- ADA BENCH SEATING
- TRASH RECEPTACLES
- VEGETATIVE BUFFERING
- 12 CONCRETE PAVEMENT, TRASH RECEPTACLES & COMMUNAL BIRD FEEDERS
- ADA COMPLIANT
- ADA BENCH SEATING
- TRASH RECEPTACLES
- VEGETATIVE BUFFERING
- 13 TRAIL MADE W/ CONCRETE PAVEMENT, TABLES AND BBQ GRILLS BY FAY PARK, INC., TYPICAL
- 14 OPEN LAWN AREA, INFORMAL PLAY
- 15 EXISTING C3 GRASS TO REMAIN
- 16 INFORMAL LAWN SOCCER FIELD (50' X 100' NCAA SOCCER)
- 17 LITTLE LEAGUE BASEBALL FIELD
- SIG-OUTS
- BACKSTOP & FENCING AT FOUL LINES
- ADA BENCH SEATING
- TRASH RECEPTACLES
- BENCH SEATING
- 18 BUFFER PLANTINGS W/ EVERGREEN GREEN TREES
- 19 PEDESTRIAN CONNECTION W/ PARKING LOT
- 20 DOG PARK (1) (60' X 40') W/ 6'-0" WIDE PLAY, INC.
- ADA COMPLIANT
- ADA BENCH SEATING
- TRASH RECEPTACLES
- VEGETATIVE BUFFERING
- PET WASTE STATIONS
- ACCENT PLANTINGS AROUND PERIMETER
- 21 EVERGREEN SCREEN TREES, TYPICAL
- 22 SPECIOUS CANOPY SHADE TREES, TYPICAL
- 23 FLOWERING ACCENT TREES, TYPICAL
- 24 STREET TREES PER CITY OF ANTIOCH DESIGN GUIDELINE, TYPICAL
- 25 CONCRETE SEAT WALL W/ SHADE TREE

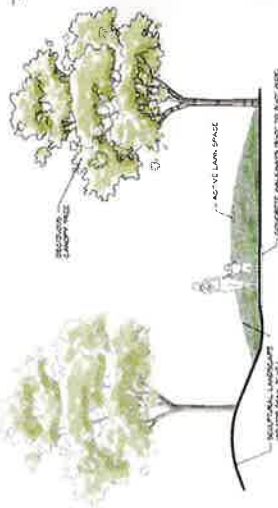

1 SCULPTURAL LANDSCAPE MOUND SECTION
(SEE PLAN FOR LOCATION)

CONCEPTUAL LANDSCAPE PLAN

NOT FOR CONSTRUCTION

PLAY EQUIPMENT



Play Structure for 2-5 age by Miracle Playsystems, Inc.



Play Structure for 5-12 age by Miracle Playsystems, Inc.

SPORTS COURTS



Basketball Court w/ Asphalt Paving (BAYSO NCAA)



Soccer Field Overlay by Baseball Field

**CONCEPTUAL LANDSCAPE PLAN
INSPIRATIONAL IMAGES**

NOT FOR CONSTRUCTION

RESTROOM FACILITIES



PARK LANDSCAPE



SITE AMENITIES



Steel Bike Rack (6 bikes) by Kay Park & Recreation



3-Point Shade Sail Structure by USA Shada, Inc.



Dogpoop Station by Kay Park & Recreation

ADA Drinking Fountain w/ Pet Fountain Attachment by Kay Park & Recreation



Galvanized Chain Link Fence by All American Fence



Concrete Picnic Table by Kay Park & Recreation



Adjustable Park Grill by Kay Park & Recreation (37" Ht./ In-ground Mounted)



Trash & Recycling Receptacles by Kay Park & Recreation



6'-0" Long Steel Bench w/ Arms by Kay Park & Recreation

PARK RIDGE PARK
City of Antioch, Contra Costa County, California



MATCHLINE, SEE SHEET L-4

MATCHLINE, SEE SHEET L-4

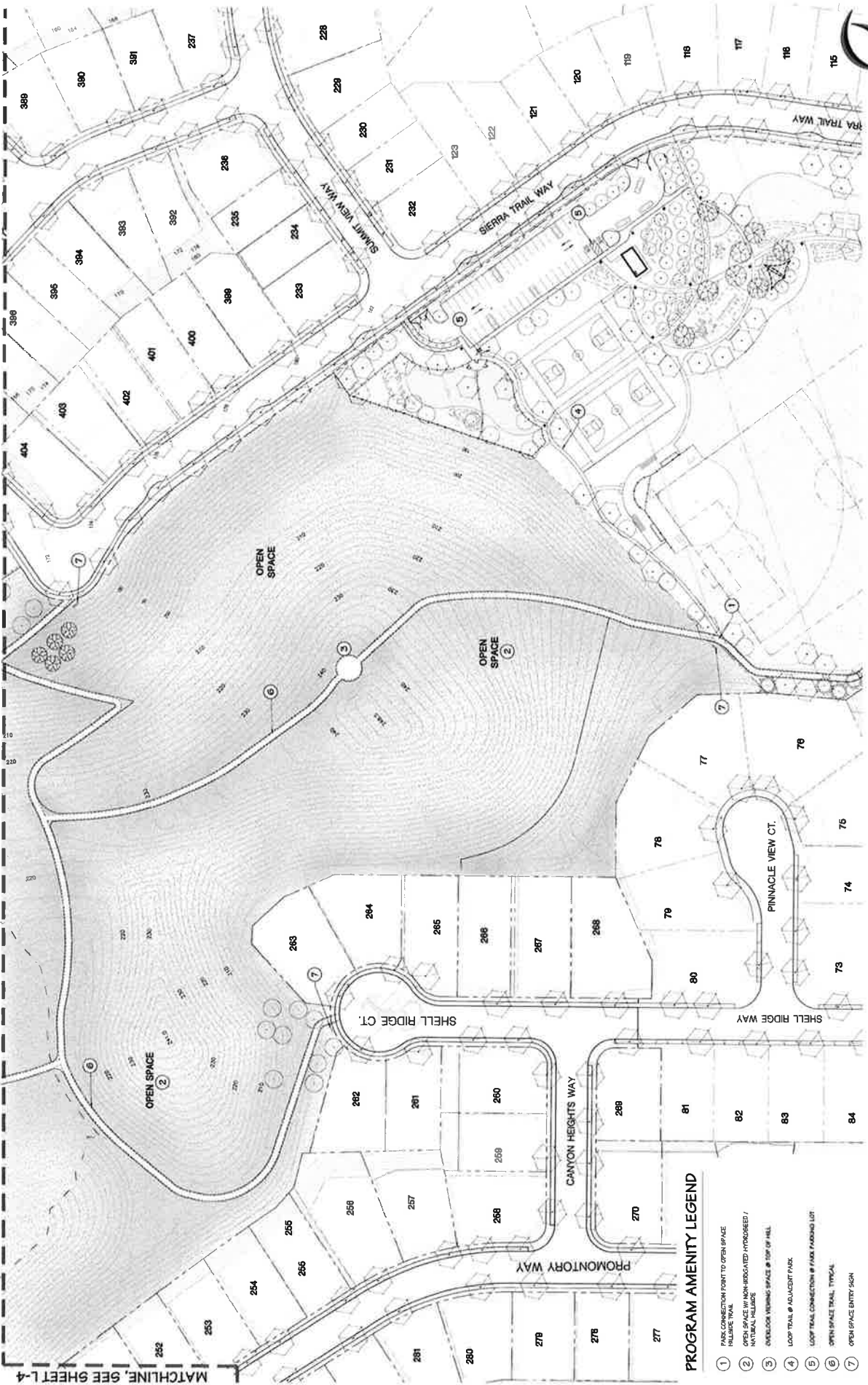

PROGRAM AMENITY LEGEND

- 1 TRAIL CONNECTION POINT TO OPEN SPACE
- 2 OPEN SPACE WITH PROPOSED HYDROBENT / NATURAL RELEASE
- 3 ON-SITE OPEN SPACE @ TOP OF HILL
- 4 LOOP TRAIL @ ADJACENT PARK
- 5 LOOP TRAIL CONNECTION @ ADJACENT LOT
- 6 OPEN SPACE TRAIL, TYPICAL
- 7 OPEN SPACE ENTRY SIGN

HILLSIDE OPEN SPACE TRAIL
(TYPICAL TREATMENT)

City of Antioch, Contra Costa County, California



0 20 40 80 FT.



ENVIRONMENTAL FORESIGHT, INC.
Landscape Architecture
10000 Lakeside Blvd., Suite 100
Walpole, CA 94597
T (925) 942-0300
www.environmentalforesight.com



CONCEPTUAL LANDSCAPE PLAN

NOT FOR CONSTRUCTION

DATE: 06/20/20
L-3
3 of 4

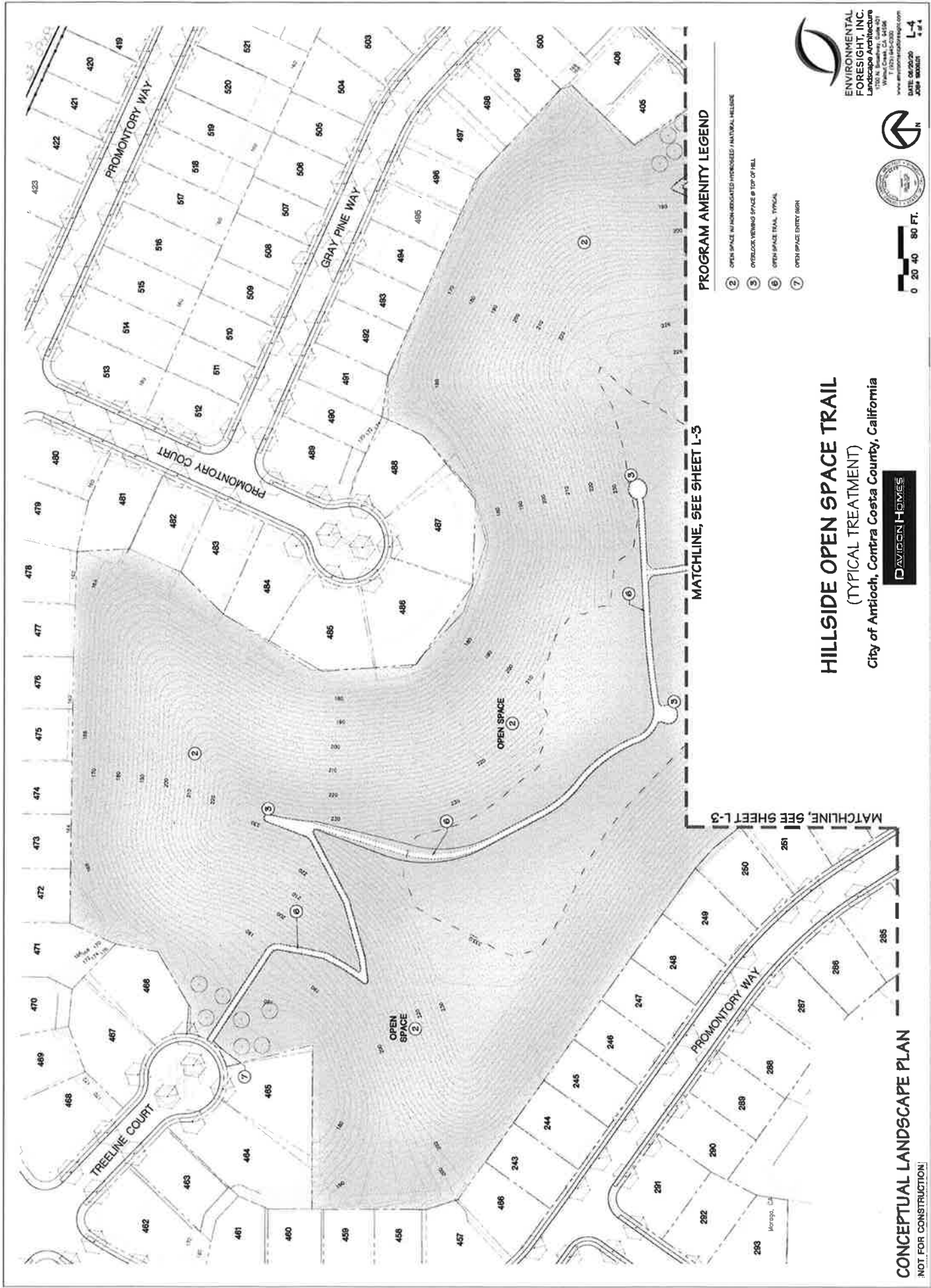

PROGRAM AMENITY LEGEND

- ② OPEN SPACE WITH INDICATED HYDROSEDS / NATURAL RELEASE
- ③ OVERLOOK VIEWING SPACE @ TOP OF HILL
- ④ OPEN SPACE TRAIL, TYPICAL
- ⑦ OPEN SPACE ENTRY (AWN)

ENVIRONMENTAL
 FORESIGHT, INC.
 Landscape Architecture
 1700 N. Sandberg, Suite 421
 Vista, CA 92083
 T (760) 943-0300
 www.environmentalforesight.com



HILLSIDE OPEN SPACE TRAIL
 (TYPICAL TREATMENT)

City of Antioch, Contra Costa County, California



MATCHLINE, SEE SHEET L-3

MATCHLINE, SEE SHEET L-3

CONCEPTUAL LANDSCAPE PLAN
 NOT FOR CONSTRUCTION!



ENVIRONMENTAL
FORESIGHT, INC.
Landscape Architecture

Park Ridge Park - Antioch, California

ESTIMATE OF PROBABLE COSTS - 06/25/20

Based on the 'Preliminary Landscape Plan' dated 06/25/20

DESCRIPTION	UNIT	QTY	UNIT PRICE	TOTAL
Site Preparation & Grading				
Mobilization, Erosion Control, Staking & Layout & Const. Fencing	LS	1	\$ 200,000.00	\$ 200,000.00
Rough Grading	SF	370,000	\$0.45	\$166,500.00
			Sub-total	\$ 366,500.00
Civil Utilities				
Storm System, Domestic Water, Sewer & Drainage	LS	1	\$200,000.00	\$200,000.00
			Sub-total	\$ 200,000.00
Site Lighting & Electrical Utilities				
12' light poles, meter pedestal, controls & trenching (not including parking lot)	LS	1	\$90,000.00	\$90,000.00
			Sub-total	\$ 90,000.00
Hardscape				
Standard Concrete Pedestrian Paving (no color)	SF	20,277	\$ 12.00	\$ 243,324.00
Asphalt Paving at Parking Lot	SF	16,926	\$ 4.50	\$ 76,167.00
Parking Lot Curbs	LF	790	\$ 20.00	\$ 15,800.00
Decomposed Granite Paving	SF	8,870	\$ 7.00	\$ 62,090.00
Basketball Court Paving with Line Striping	SF	16,000	\$ 6.50	\$ 104,000.00
Play Surface (Poured in Place Resilient Surface)	SF	4,252	\$ 22.00	\$ 93,544.00
Concrete Seat Walls	LF	36	\$ 180.00	\$ 6,480.00
			Sub-total	\$ 601,405.00
Site Furnishings				
Picnic table	EA	9	\$3,500.00	\$31,500.00
Bench	EA	12	\$2,500.00	\$30,000.00
Bike Racks (6 bikes each)	EA	2	\$1,000.00	\$2,000.00
Trash & Recycling Receptacles (Pair)	EA	4	\$2,400.00	\$9,600.00
Drinking Fountains	EA	3	\$8,000.00	\$24,000.00
Dog Waste Disposal w/ Trash Can	EA	2	\$600.00	\$1,200.00
Charcoal Grill	EA	4	\$600.00	\$2,400.00
Tree Grates	EA	3	\$1,200.00	\$3,600.00
			Sub-total	\$ 104,300.00
Site Structures				
Restroom (w/ drinking fountains)	EA	1	\$130,000.00	\$130,000.00
Play structure - (5-12 yrs)	EA	1	\$80,000.00	\$80,000.00
Play structure - (2-5 yrs)	EA	1	\$65,000.00	\$65,000.00
Shade Sail (38' x 29')	EA	1	\$18,000.00	\$18,000.00
Swing Set	EA	1	\$8,000.00	\$8,000.00
Basketball Hoops	EA	4	\$6,000.00	\$24,000.00
Baseball Field (Backstop, Dugouts, Bleacher & Fencing)	LS	1	\$35,000.00	\$35,000.00
3'-6" HT. Galvanized Chain Link Fence (Dog Park)	LF	640	\$18.00	\$11,520.00
Entry Monument Sign	EA	1	\$8,000.00	\$8,000.00
Double Vehicular Gate	EA	2	\$8,000.00	\$16,000.00
			Sub-total	\$ 395,520.00
Irrigation				
Shrub Bubbler	SF	97,035	\$ 3.00	\$ 291,105.00
Lawn Spray	SF	198,992	\$ 1.00	\$ 198,992.00
Tree Bubbler - On-grade	EA	201	\$ 125.00	\$ 25,125.00
Controllers	LS	1	\$ 35,000.00	\$ 35,000.00

1700 N. Broadway, Suite 401, Walnut Creek, California 94596,
T (925) 945-0300

E info@environmentalforesight.com, W www.environmentalforesight.com

Sub-total \$ 550,222.00

Planting

24" Box Trees	EA	5	\$	350.00	\$	1,750.00
15 Gallon Trees	EA	196	\$	200.00	\$	39,200.00
Shrubs & Groundcovers (5 gal, 1 gal) & Soil Prep	SF	97,035	\$	4.50	\$	436,657.50
Turf Lawn	SF	198,992	\$	1.00	\$	198,992.00
Bark Mulch	SF	97,035	\$	0.35	\$	33,962.25
Header (Plastic)	SF	1,270	\$	6.00	\$	7,620.00
Sculptural Mound Fine Grading	CY	460	\$	15.00	\$	6,900.00
				Sub-total	\$ 725,081.75	

Maintenance

Maintenance Cost Per City of Antioch

TBD

Total Landscape Estimate of Probable Costs \$ 3,033,028.75

Contingency (10%) \$ 303,302.88

GRAND TOTAL \$ 3,336,331.63

ASSUMPTIONS

1. This Cost Estimate is for conceptual budget purposes only and does not reflect a firm construction price.
2. The final contractor's estimate may vary based upon prevailing contractor cost of material and labor.
3. The following are **not** included in this Cost Estimate:
 - a. Domestic Water Meter
 - b. Irrigation Water Meter

**STAFF REPORT TO THE
PARKS AND RECREATION COMMISSION**

DATE: Regular Meeting of August 20, 2020
TO: Parks and Recreation Commission
SUBMITTED BY: Nancy Kaiser, Parks and Recreation Director *Nancy Kaiser*
SUBJECT: **ORAL REPORT ON COVID-19 UPDATES AND PROJECTIONS THROUGH 2020**

Staff will provide an update on the status of COVID-19 impacts on City facilities and programs, as well as projections for the remainder of the year.